

# Exhibition TV Stand



**Unique and innovative design**  
2" incremental spring plungers height adjustment innovative mechanism design provides effortless viewing level setup from 40.5" to 60.2".

**Height adjustable video tray**  
Steel video tray holds components up to 10 lbs (4.5 kg) and able to adjust vertical freely within the slot length for perfect video conferencing position.

**Adjustable AV shelf height**  
Adjustable plastic AV shelf holds AV components and accessories up to 10lbs (4.5 kg).

**High tensile heavy gauge material used to construct solid base for better support, stability and rigidity !**

**Integrated cable management system**  
Internal cable management allows cables and wires to be routed inside the column for clean, clutter-free look.

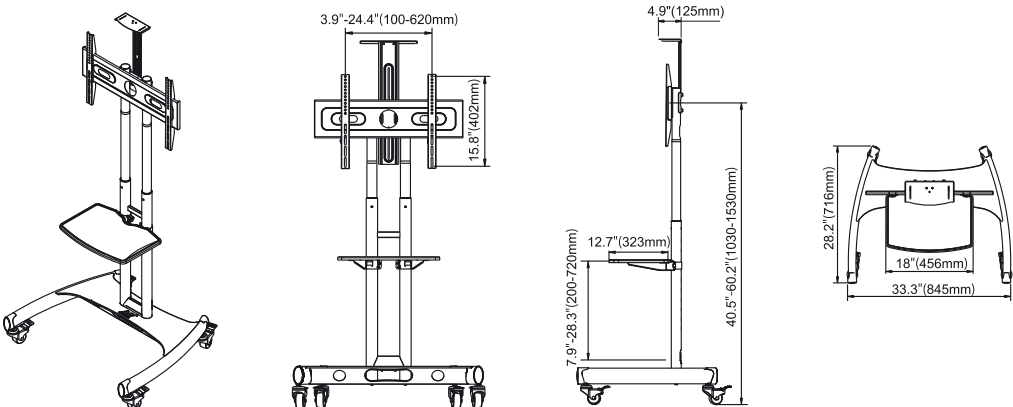
**Swivable caster brake wheels**  
Carts come with 2" swivable caster brake wheels provide you with easy maneuvers to any direction and position.

**Heavy gauge columns constructed**  
Built in 2X SPCC seamless heavy gauge columns provides rigid and stable support for the full setup mass weight.

## SPECIFICATIONS

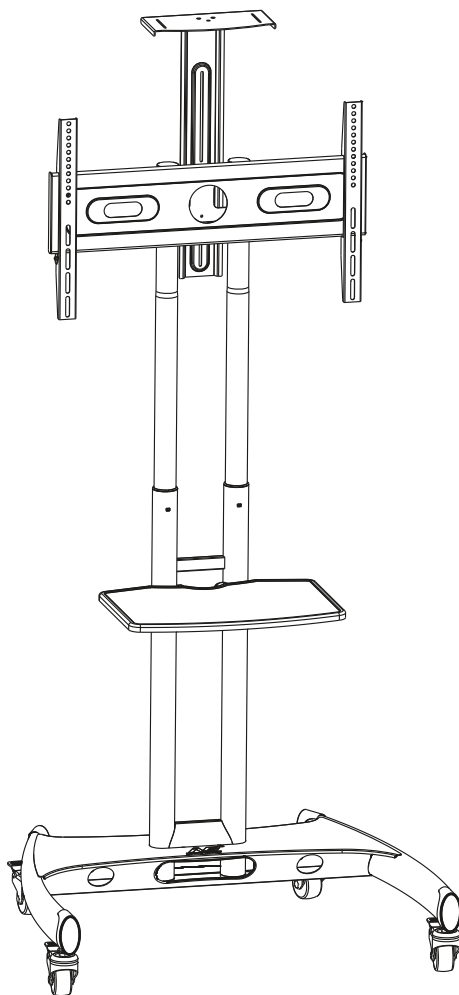
TV size	Max load	VESA pattern	Tilt angles	Swivel angles	Height adjustment	Materials used
37"-65"	100lbs(45.5kg)	100*100-600*400mm	0°	0°	40.5"-60"(1030-1530mm)	SPCC seamless

## LINE DIMENSIONS



See website for more information

# INSTALLATION INSTRUCTION



## **Multi-functional and professional mobile stand**

**For TV panels: 40"-60"**

**Maximum load capacity: 100 lbs / 45.5 kg**

**AV shelf max load: 10 lbs / 4.5 kg**

**Video tray max load: 10 lbs / 4.5 kg**

**VESA: 100x100-600x400mm**

# Table of Contents

Table of Contents and Warning 2/11

Parts list 3/11

Assembly and Installation

1. 1 Castor wheels to base installation 4/11

1. 2 Post assembly to base installation 4/11

2. Install telescopic mounting poles 5/11

3. Av shelf assembly and installation 6/11

4. Installation of interface 7/11

5. Selection of TV mounting patterns 8/11

6. Mounting TV on pole interface 9/11

7. Video tray installation 10/11

8. Cables and wires installation 11/11

## WARNING!

Severe personal injury and property damage can result from improper installation or assembly. Read the following warning carefully before beginning.

- If you do not understand the instructions or have any concerns or questions, please contact a qualified local installer.

● Do not install or assemble if the product or hardware is damaged or missing, if you require replacement parts, please contact your local distributor for assistance.




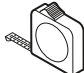



● This product fits most 40"-60" LCD/plasma screen; maximum weight of LCD/plasma screen:100lbs/45.5kg;AV shelf max load:10lbs/4.5kg;Video tray max load:10lbs/4.5kg.

● Do not use this product for anything other than the original design.

● This product contains moving parts, please use with caution.

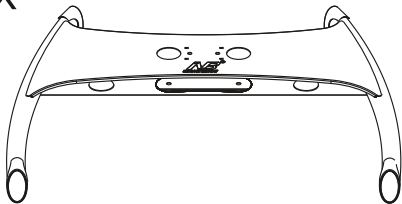
● The manufacturer disclaims any liability for the modifications, improper installation, or installation over the specified weight range. The manufacturer will not be liable for any damages arising out of the use of, or inability to use, the product.
- All images are for reference, to prevail in product.

## Manual

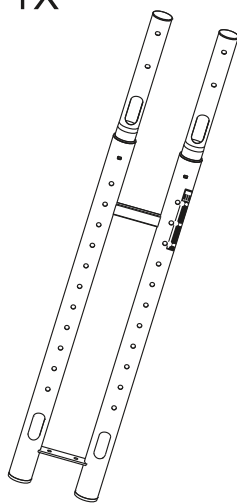
						
Tightening Direction	loosening Direction	Phillips Screwdriver	Metre Rule	Adjustment	By Hand	Hex Wrench

Parts List

1X



1X



4X



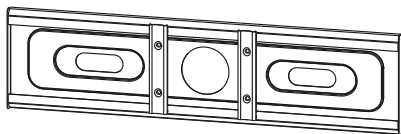
1X



1X



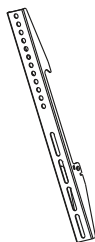
1X



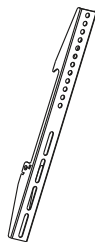
1X



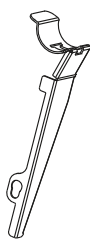
1X



1X



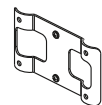
1X



1X



1X



4X



1X



2X



A1  
4X



M8×25mm

B1  
4X



M6×25mm

C1  
4X



M5×25mm

D1  
4X



Φ16×Φ6.2×1.5mm

E1  
4X



Φ18×27×H14mm

A2  
6X



M8×26mm

B2  
4X



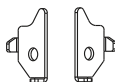
M8×55mm

C2  
2X



M5×12mm

D2  
1X



E2  
4X



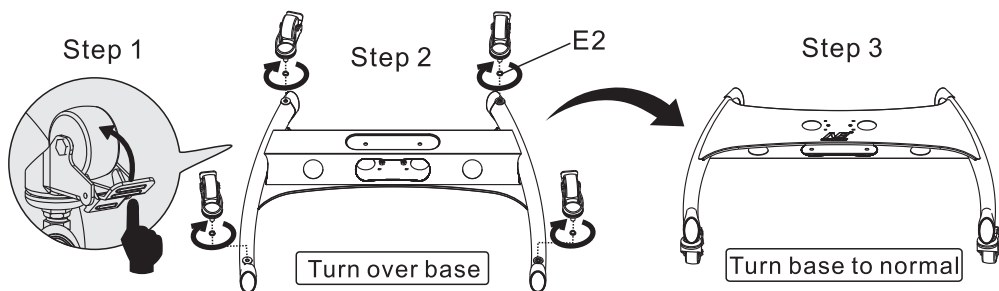
Φ16.5×Φ12.5×2mm

F2  
1X

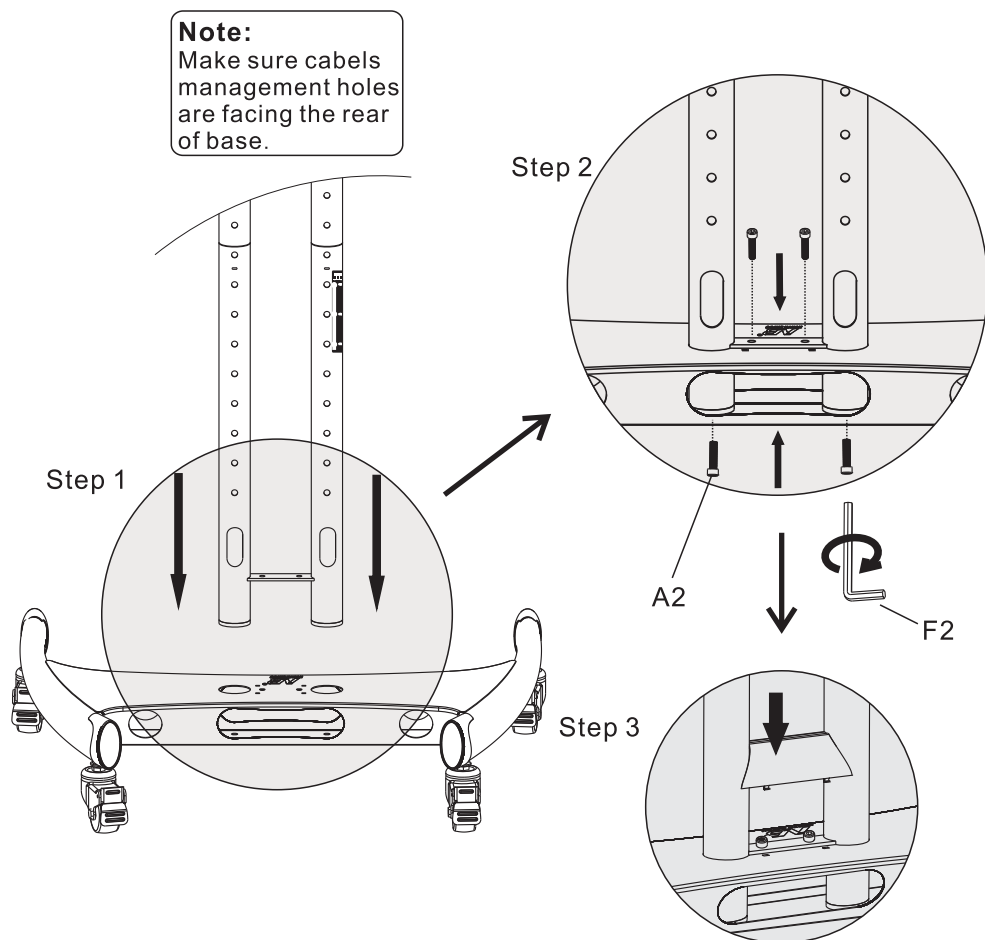


M6

## 1.1 Castor wheels to base installation



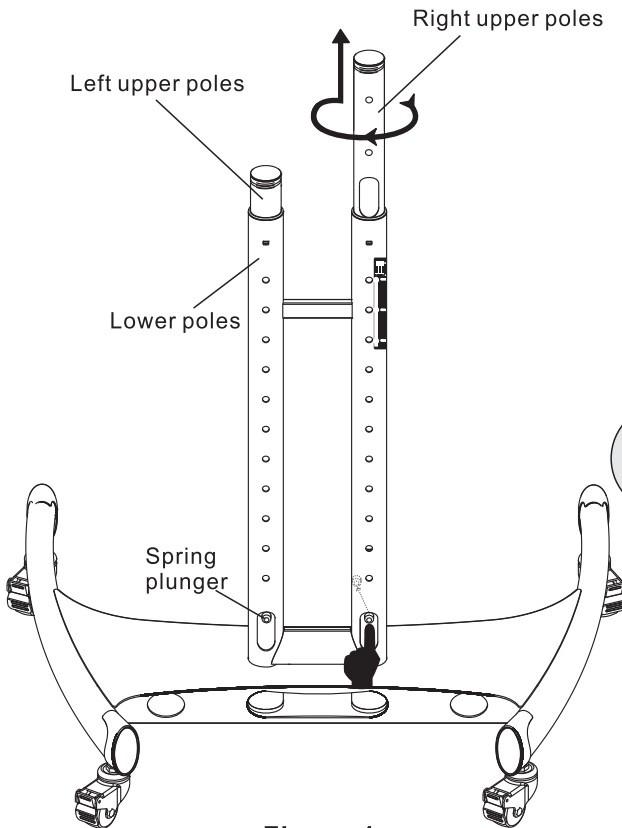
## 1.2 Post assembly to base installation



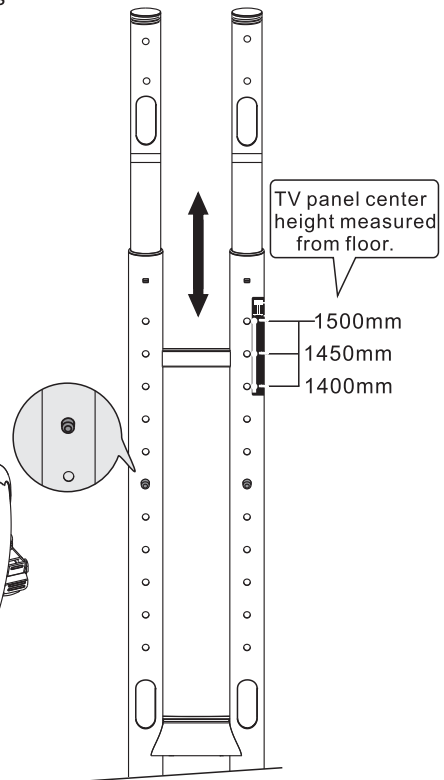
## 2. Install telescopic mounting poles

Step 1. Use thumb or finger to depress the right upper pole spring plunger ball located at the cable window, pull upper pole upward until your desired height. Twist upper pole toward the plunger holes direction and engage the spring ball into the plunger hole and set as shown in fig-1.

Step 2. Repeat with left pole.

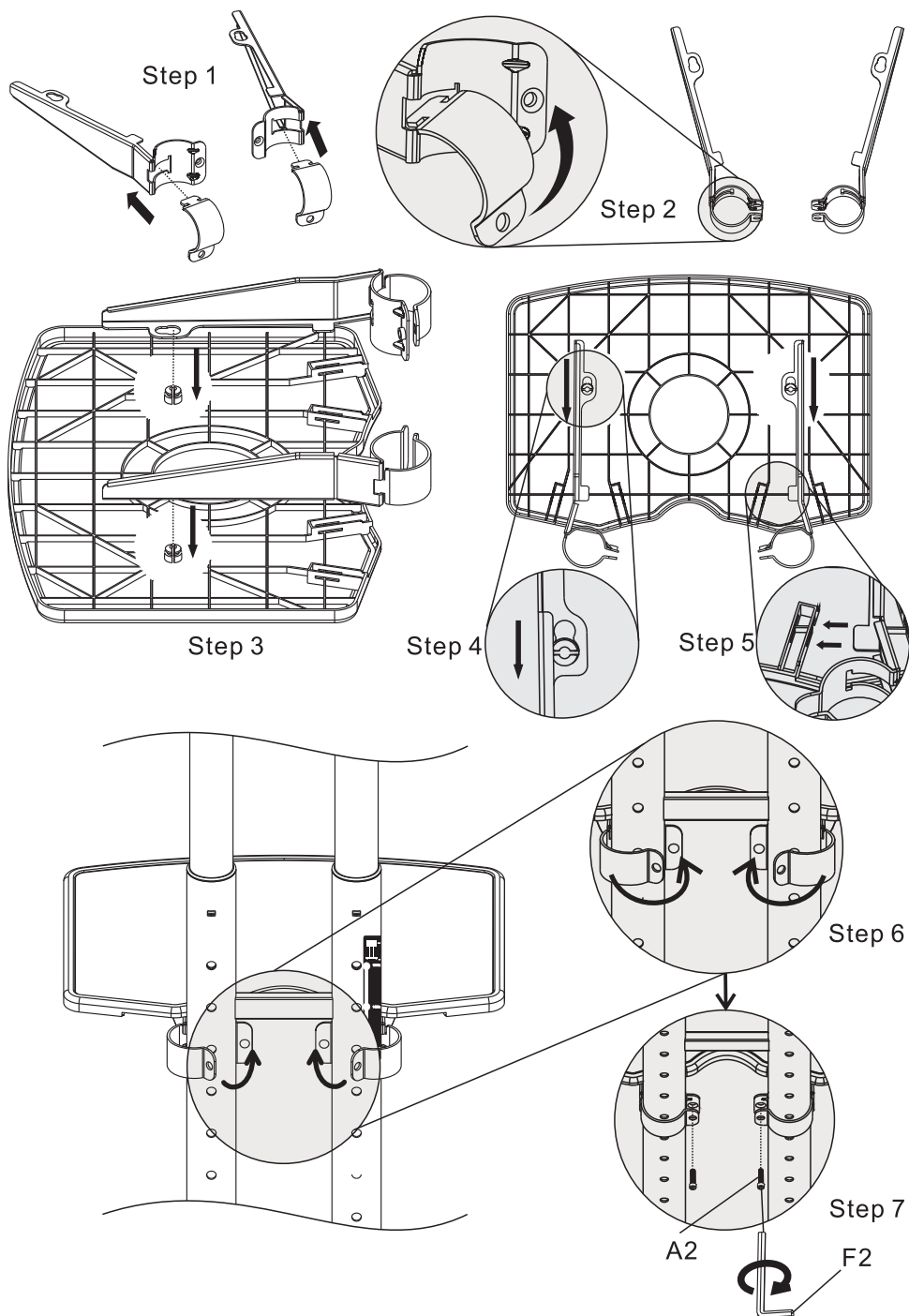


**Figure 1**



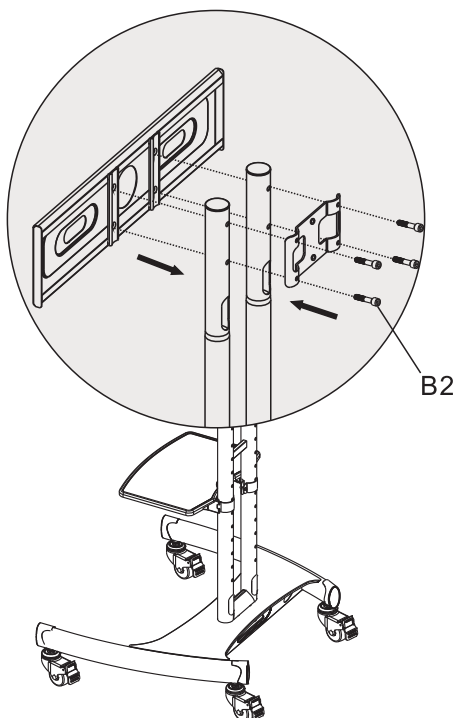
**Figure 2**

### 3. AV shelf assembly and installation

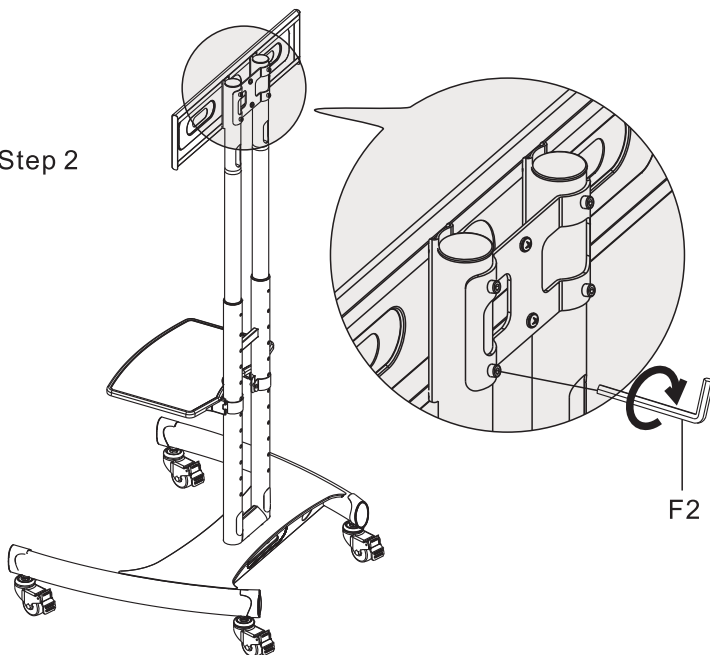


## 4. Installation of interface

Step 1



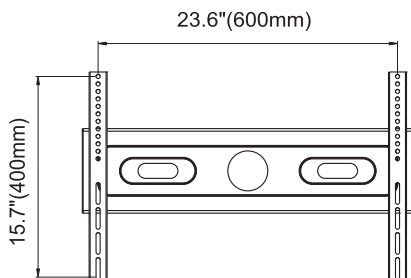
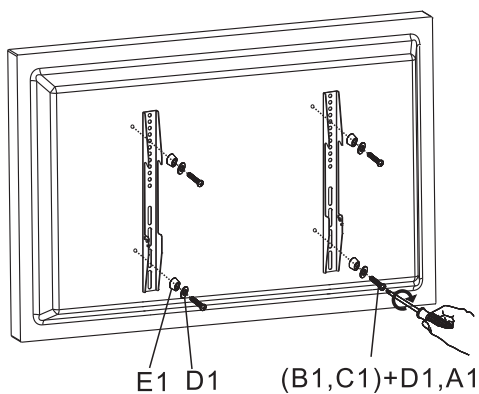
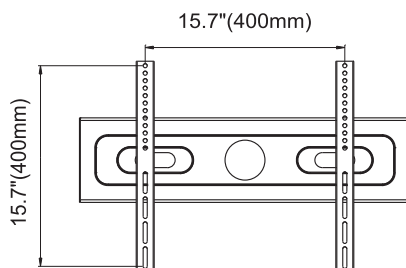
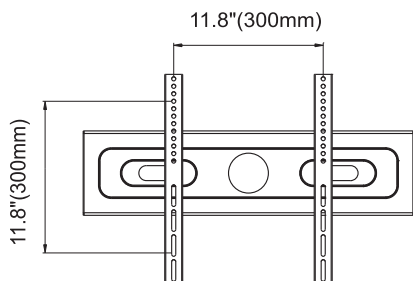
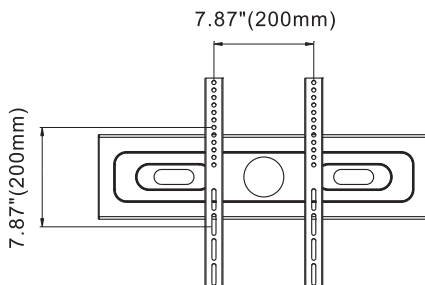
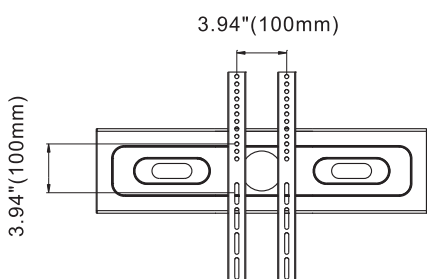
Step 2





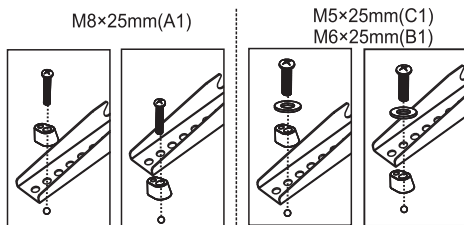
## 5. Selection of TV mounting patterns

VESA: 100x100~600x400mm

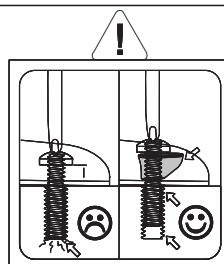


### Note:

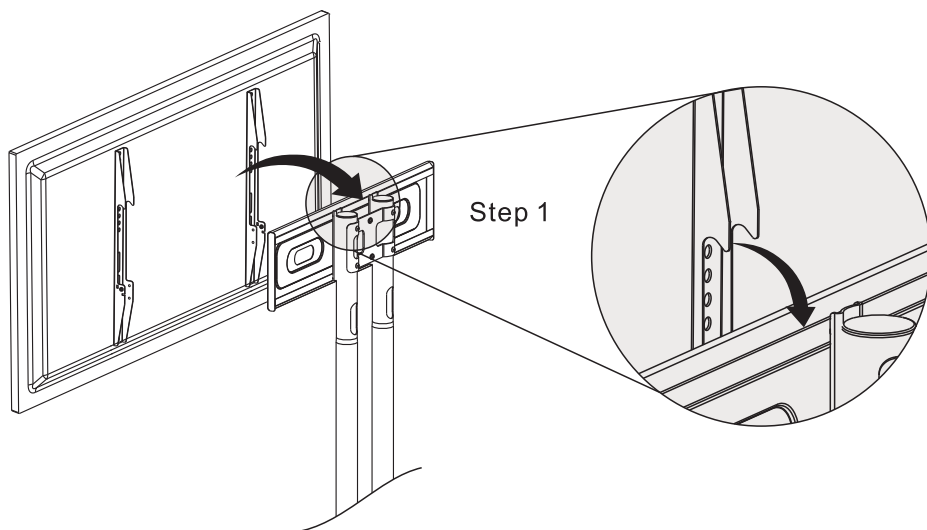
To avoid damage plastic spacer must be used when depth of mounting holes is minimal.



Safety advise

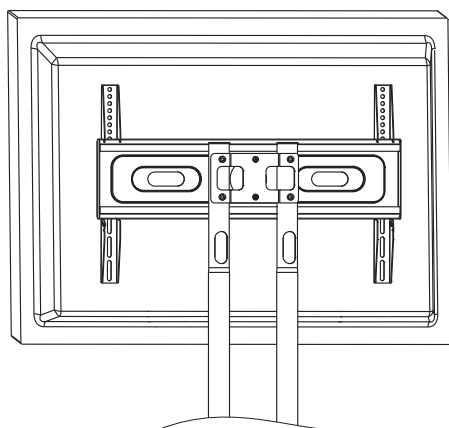


## 6. Mounting TV on pole interface

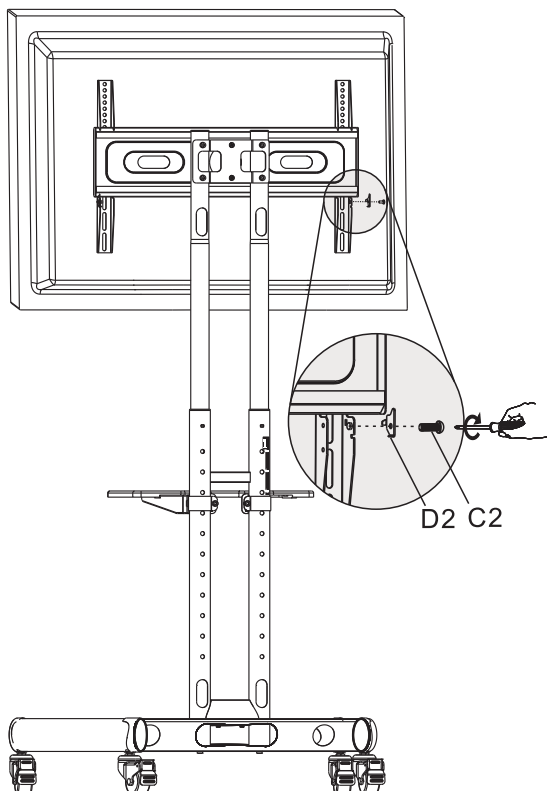


Step 2

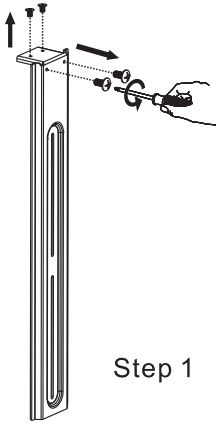
**Note:**  
Moves TV to center.



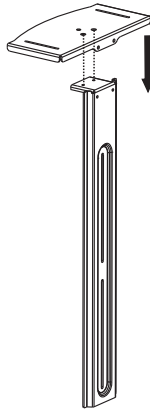
Step 3



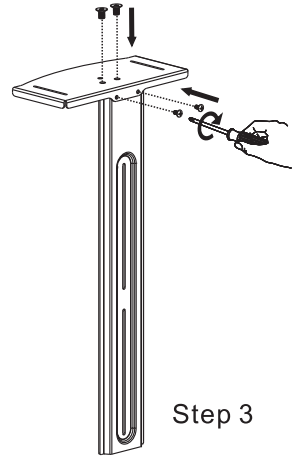
## 7. Video tray installation



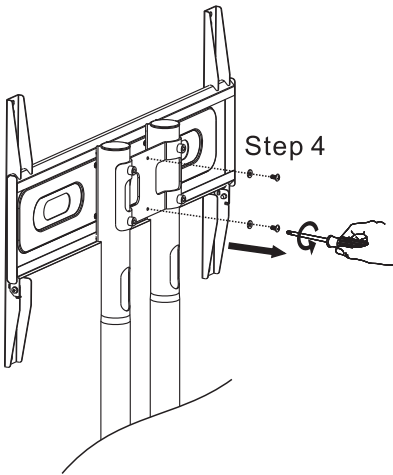
Step 1



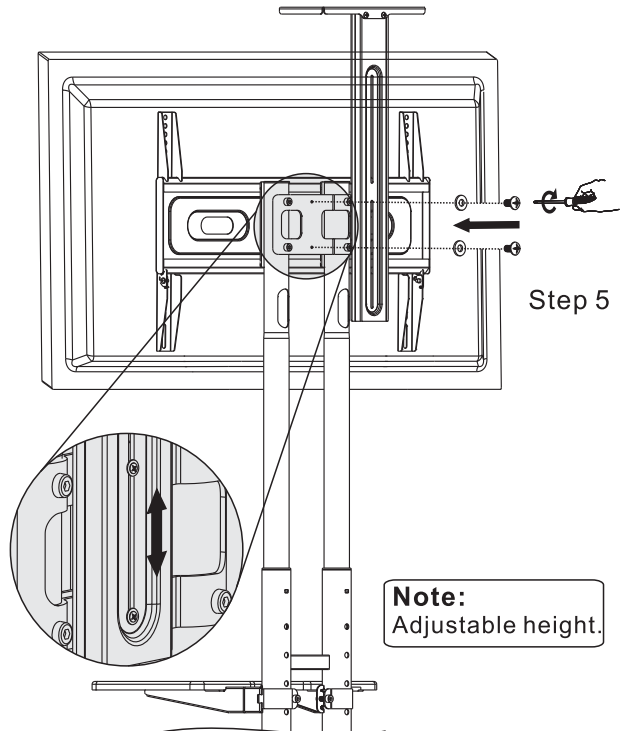
Step 2



Step 3



Step 4



Step 5

**Note:**  
Adjustable height.

## 8. Cables and wires installation

